

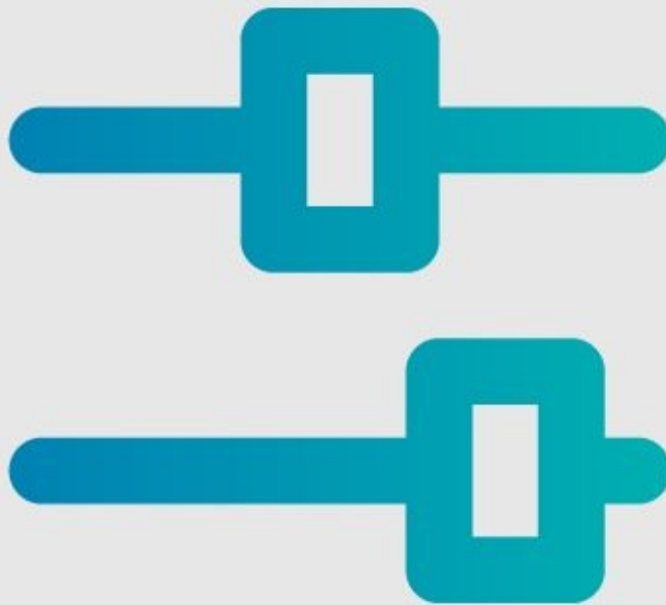

Assigning a Work Order ID in Operator View URLs

Assigning a Work Order ID

Written By: Dozuki System



INTRODUCTION

This guide demonstrates how to create a work order number with a parameter, and it tells why a work order number with a parameter is helpful.

Why is this important?

Dozuki uses Work Order IDs as a way to better identify each entry of a guide in Operator View. Each entry has a unique sequentially-generated entry ID. Work Order IDs are user-specified, which helps with reporting.

Here are a few use cases in which adding this parameter streamlines workflow:

- When starting a guide in Operator View, entering a Work Order ID saves time.
- When you start a guide in Operator View, you can error-proof a Work Order ID entry.
- You can tie a specific Work Order ID to a URL and distribute it via a link or QR code.

This is especially useful when an existing work order number is referenced, such as from a production order in an ERP. It is also helpful when a single guide is used to audit multiple workstations with a Work Order ID in Dozuki.

Note: The Guide ID does not change, even if you change the name of the guide or work order ID.

Reminder: If **DRAFT** is at the end of the URL, this means the guide is in draft status. In this case, exit Operator View and select the latest guide release in order to create your work order ID.

Step 1 — Assigning a Work Order ID in Operator View URLs

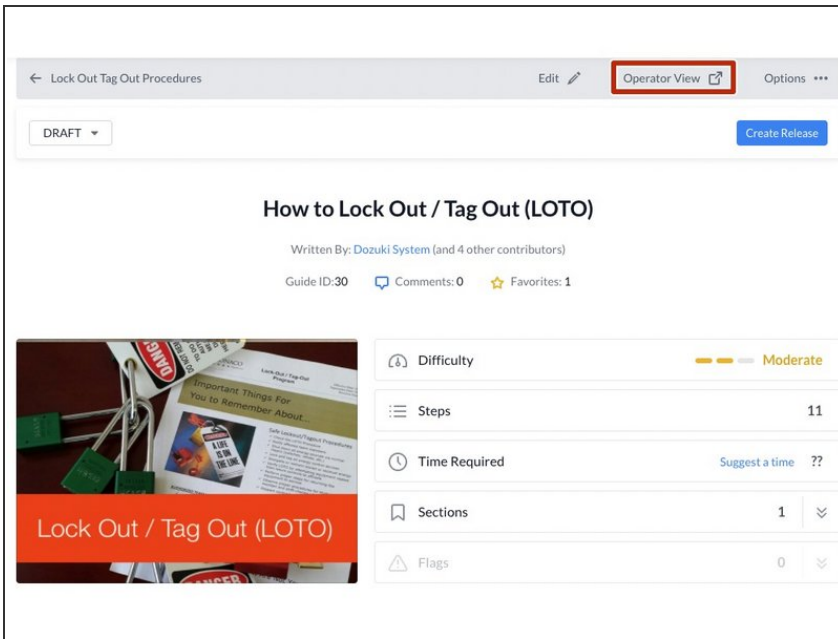

- On the draft page of the selected guide, click on the **Operator View** button.
- ❗ **Operator View** is only available on guides with data capture forms.

Step 2

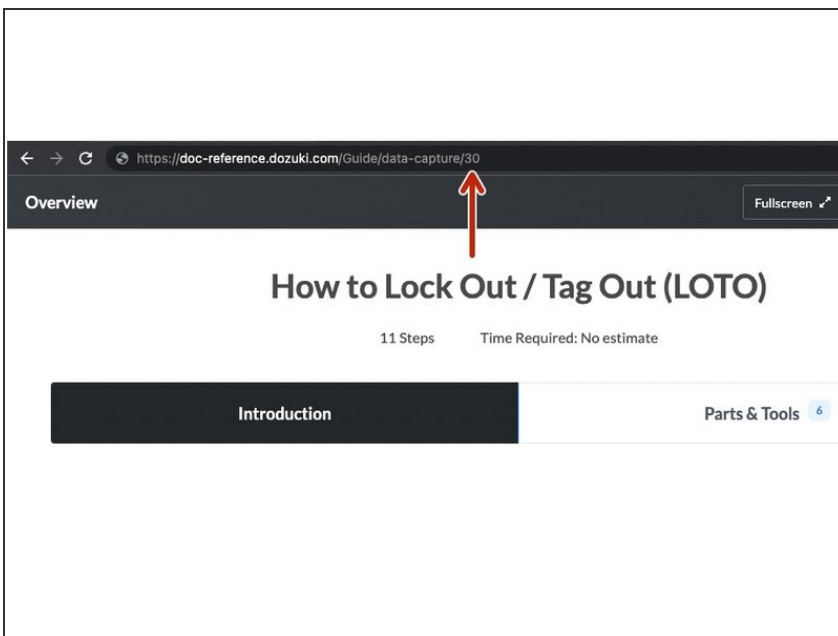

- The Guide ID is located at the end of the URL.
- ❗ In this example, the Guide ID is 30.

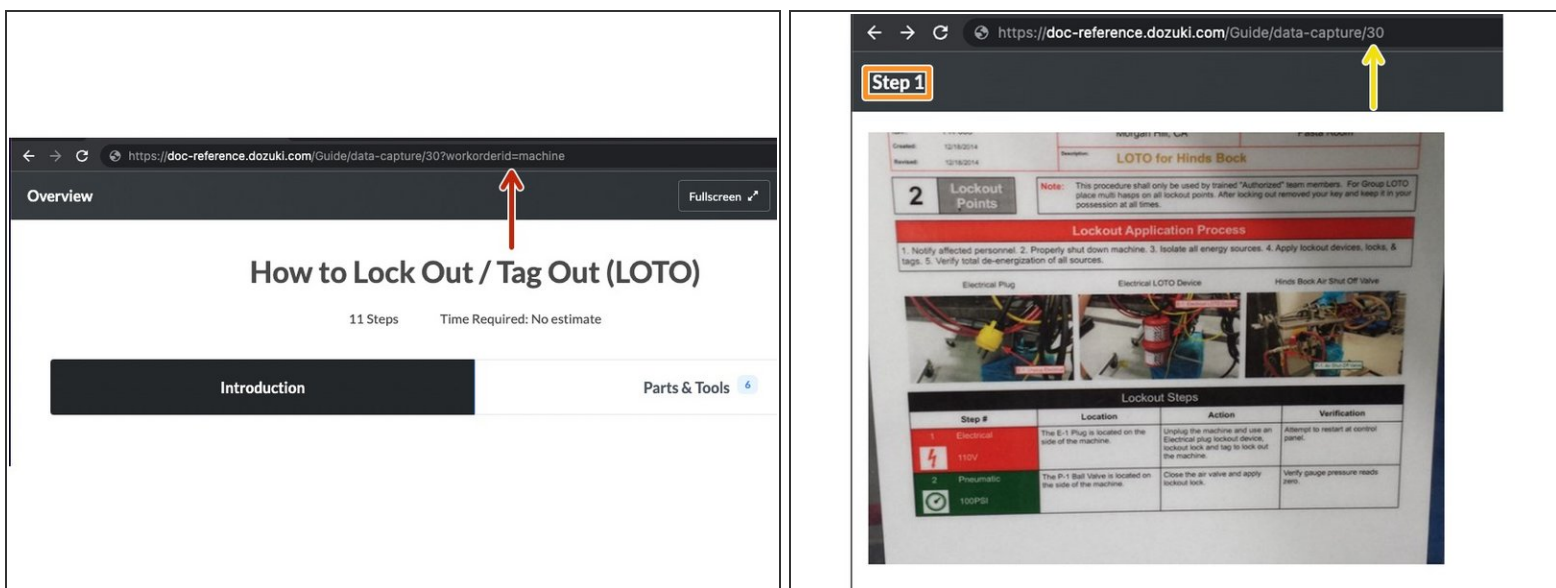

Step 3



- After the Guide ID, type in: *?workorderid=the job name, machine, or number, etc.*
 - In this example, the workorderid reads: `?workorderid=machine`.
- Once you have pre-populated the work order ID, press **Enter** on your keyboard.
 - This takes you to the first step of the guide in **Operator View**.
 - The URL will return to its original format with the guide ID at the end of the URL.

Step 4



-  With this process, you can tie a specific Work Order ID to a URL, which can then be distributed via a link or a QR code.
-  Use an external QR code generator to create a new QR code with the new work order number URL.