



How to Set up Single Sign On with Microsoft Azure

Set up single sign-on for your Dozuki site using Microsoft Azure.

Written By: Dozuki System



INTRODUCTION

Dozuki sites support single sign-on (SSO) through the SAML 2.0 protocol. Use this guide to set up a SAML2 connection with Microsoft Azure.

Step 1 — Log in to Azure

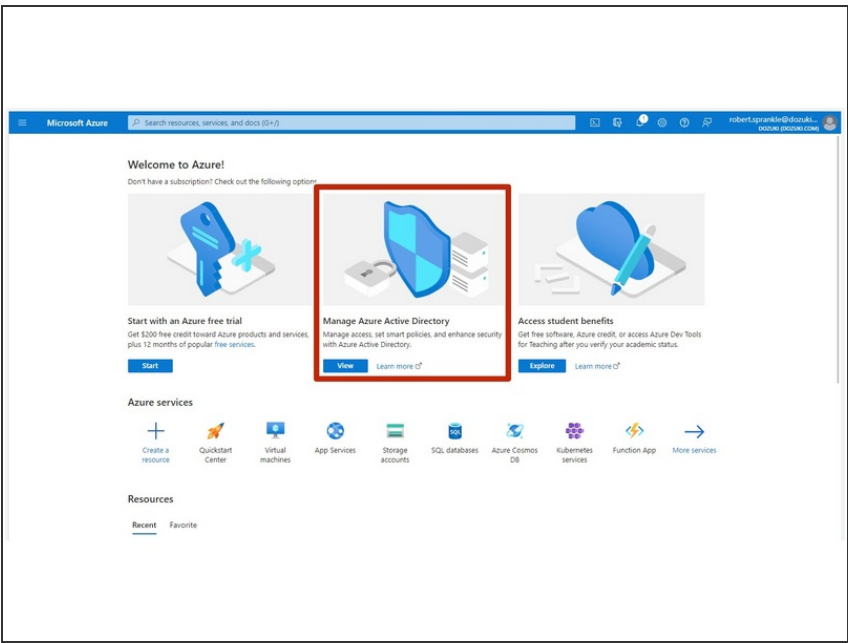

- Log in to the Azure admin portal for your organization.
- For most companies, the portal will be <https://portal.azure.com/>.
- Click the **View** button on the **Manage Azure Active Directory** tile.

Step 2

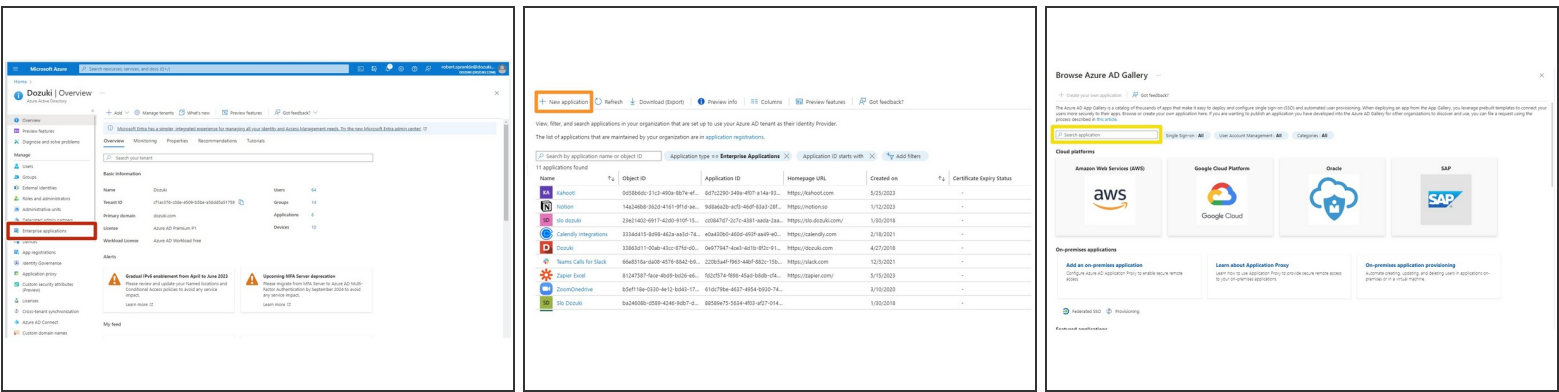

- Click on **Enterprise applications** in the **Manage** menu.
- Click on **New application** at the top of the window.
- Type **"Dozuki"** into the search bar.

Step 3

Add your own application

Name * ⓘ
Dozuki ✓

Once you decide on a name for your new application, click the "Add" button below and we'll walk you through some simple configuration steps to get the application working.

Supports: ⓘ

- SAML-based single sign-on
[Learn more](#)
- Automatic User Provisioning with SCIM
[Learn more](#)
- Password-based single sign-on
[Learn more](#)

Add

- Type a display name for your Dozuki site into the **name** field.
- ⓘ For customers with a single Dozuki site, we recommend using **Dozuki** as the display name.
- Click the **Add** button at the bottom of the window.

Step 4 — Assign a User or Group

Home > n/a > Enterprise applications | All applications > Add an application > Dozuki | Overview

Dozuki | Overview

Overview

Deployment Plan

Diagnose and solve problems

Manage

- Properties
- Owners
- Users and groups
- Single sign-on
- Provisioning
- Application proxy
- Self-service

Security

- Conditional Access
- Permissions
- Token encryption

Activity

- Sign-ins
- Usage & insights (Preview)
- Audit logs
- Provisioning logs (Preview)
- Access reviews

Troubleshooting + Support

- Virtual assistant (Preview)
- New support request

Properties

Name ⓘ
Dozuki

Application ID ⓘ
942310C5-c063-4627-92...

Object ID ⓘ
67864890-b222-4f5b-a0...

Getting Started

1. Assign users and groups
Provide specific users and groups access to the applications
[Assign users and groups](#)

2. Set up single sign on
Enable users to sign into their application using their Azure AD credentials
[Get started](#)

3. Provision User Accounts
Automatically create and delete user accounts in the application
[Get started](#)

4. Conditional Access
Secure access to this application with a customizable access policy.
[Create a policy](#)

5. Self service
Enable users to request access to the application using their Azure AD credentials
[Get started](#)

What's New

Home > Dozuki | Users and groups

Dozuki | Users and groups

Add user Edit Remove Update Credentials Columns Got feedback?

The application will appear on the Access Panel for assigned users. Set "visible to users" to no in properties to prevent this. →

First 100 shown, to search all users & groups, enter a display name.

Display Name	Object Type	Role assigned
No application assignments found		

Overview

Deployment Plan

Diagnose and solve problems

Manage

- Properties
- Owners
- Users and groups
- Single sign-on
- Provisioning
- Application proxy
- Self-service

Security

- Conditional Access
- Permissions
- Token encryption

Activity

- Sign-ins
- Usage & insights (Preview)
- Audit logs
- Provisioning logs (Preview)
- Access reviews

Troubleshooting + Support

- Virtual assistant (Preview)
- New support request

- Click on the **Assign users and groups** tile in the **Getting Started** section.
- Click the **Add user** button to add users and groups.
- ⓘ You can read more about assigning users and groups in Azure [here](#).

Step 5

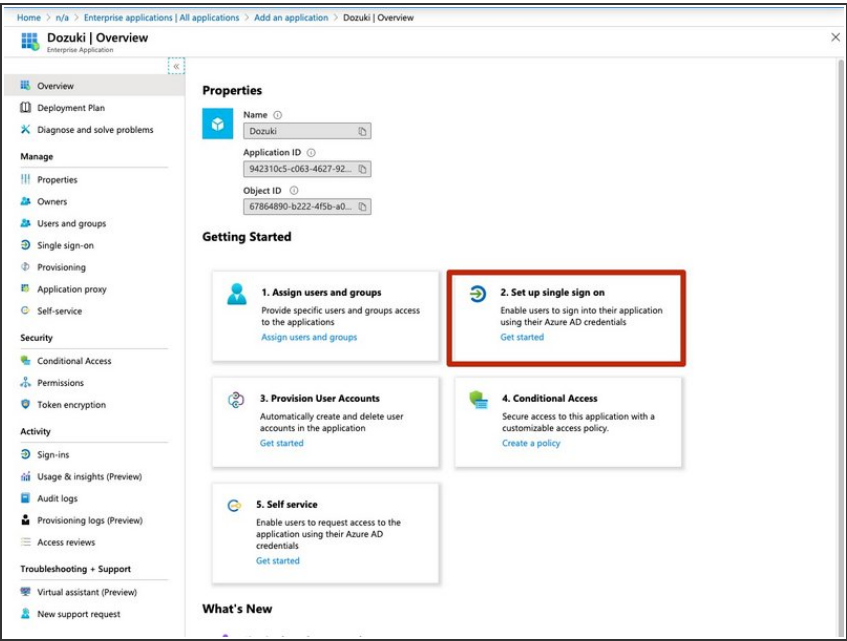

- Click on the **Set up single sign on** tile in the **Getting Started** section.

Step 6 — Select a Single Sign-on Method

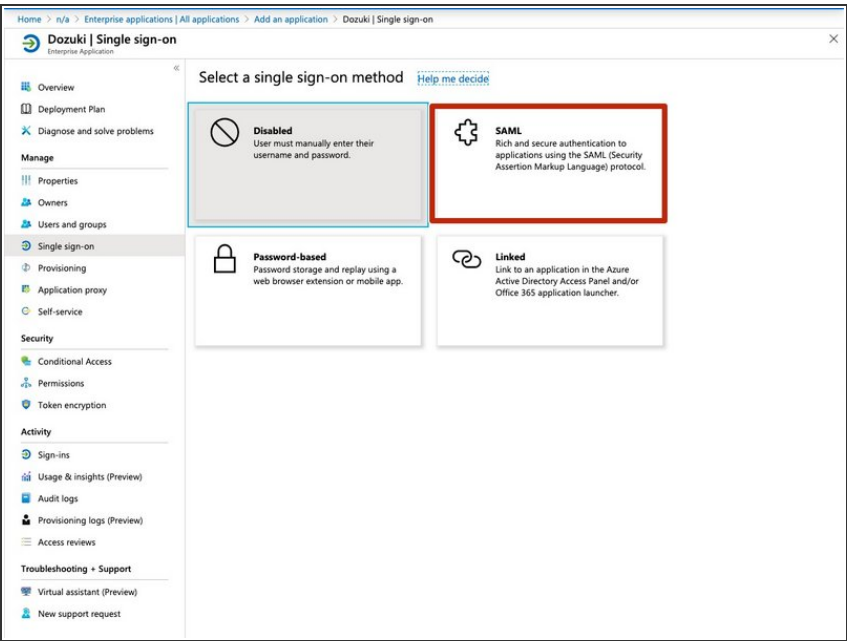

- Click on the **SAML** tile under **Select a single sign-on method**.

Step 7 — Basic SAML Configuration

Set up Single Sign-On with SAML

Read the [configuration guide](#) for help integrating Dozuki.

1

Basic SAML Configuration

Identifier (Entity ID)

Reply URL (Assertion Consumer Service URL)

Sign on URL

Relay State

Logout Url

Required

Required

Optional

Optional

Optional

2

User Attributes & Claims

givenname

surname

emailaddress

name

Unique User Identifier

user.givenname

user.surname

user.mail

user.userprincipalname

user.userprincipalname

3

SAML Signing Certificate

Status

Thumbprint

Expiration

Notification Email

App Federation Metadata Url

Certificate (Base64)

Certificate (Raw)

Active

5/5/2023, 11:52:22 AM

non.damr@outlook.com

<https://login.microsoftonline.com/b16b38fe-3f...>

Download

Download

- Click the **edit icon** on the **Basic SAML Configuration** tile.

Step 8

Configuration

General

Appearance

Security

Translation Glossary

Users

Organization

Content Review

Document Control

Timeline

Support

Reports

Services

General

Plan	factory	
Title	Heather	Edit
Description	<your site description will go here>	Edit
Home page	Guide	Edit
Custom domain	Not using a custom domain	Edit
Alternate domain aliases	No Value Set	Edit
E-commerce link	No Value Set	Edit
Google Analytics key	No Value Set	Edit
Mobile apps	Your site is not listed in the Dozuki mobile apps.	Edit
Persistent API Token	8IfjgplYh0r aPZ48N0ir 9e9cTe1S23bZs	Edit
Footer site statistics	Your site's view statistics will be displayed in the site footer.	Edit

Guides

Default guide conclusion	Caterpillar: Confidential Green	Edit
Automatic guide titles	Automatic generation of guide titles is disabled	Edit

Authentication

Single sign on

Single sign on: disabled. Login and account creation on this site happens normally.

Edit

Dozuki SSO: URL	No Value Set	Edit
Dozuki SSO: Logout URL	No Value Set	Edit
Dozuki SSO: Secret	No Value Set	Edit
SAML 2.0: Identity Provider Entity ID	No Value Set	Edit
SAML: Identity provider URL	No Value Set	Edit
SAML Metadata	Download Metadata	
SAML: Logout URL	No Value Set	Edit
SAML: Identity Provider X.509 Certificate	No Value Set	Edit
Google Login	Google login is disabled	Edit

ABOUT HELP API

- Open the management console of your Dozuki site in another browser window.
- From the **Configuration** section in the sidebar menu, select **Security**.
- Download the SAML `metadata.xml` file.
 - 📁 Open this file with text editor.

Step 9

ta file

Change single sign-on mode

Sign-On with SAML

on based on federation protocols improve
AML single sign-on whenever possible for

on guide for help integrating Dozuki.

Configuration

Entity ID (Assertion Consumer Service URL)
https://ssosamtesting.dozuki.com/

Index
https://ssosamtesting.dozuki.com/Guide/User/remote_login 1

Sign on URL (Optional)
Enter a sign on URL

Relay State (Optional)
Enter a relay state

Logout URL (Optional)
https://ssosamtesting.dozuki.com/Guide/logout

& Claims

user.s
user.s
user.f
user.f
user.f

er Identifier

ificates

ing certificate

t

1 Email
tion Metadata Uri
(Base64)
(Base64)

Down
Pinout

Basic SAML Configuration

Save Got feedback?

Identifier (Entity ID) *
The unique ID that identifies your application to Azure Active Directory. This value must be unique across all applications in your Azure Active Directory tenant. The default identifier will be the audience of the SAML response for IDP-initiated SSO.

https://ssosamtesting.dozuki.com/

Add identifier

Reply URL (Assertion Consumer Service URL) *
The reply URL is where the application expects to receive the authentication token. This is also referred to as the "Assertion Consumer Service" (ACS) in SAML.

https://ssosamtesting.dozuki.com/Guide/User/remote_login 1

Add reply URL

Sign on URL (Optional)
Sign on URL is used if you would like to perform service provider-initiated single sign-on. This value is the sign-in page URL for your application. This field is unnecessary if you want to perform identity provider-initiated single sign-on.

Enter a sign on URL

- Enter the **Basic SAML Configuration** settings.
 - ✎ Refer to the values in the SAML `metadata.xml` file.
 - ⓘ Alternatively, you can use the **Upload metadata file** tab to upload these values directly into Azure.
- Click the **Save** icon to save your changes.
- Click the 'X' at the top of the window to leave the **Basic SAML Configuration** settings.

Step 10 — Set User Attributes and Claims

Set up Single Sign-On with SAML

Read the [configuration guide](#) for help integrating Dozuki.

1

Basic SAML Configuration

Identifier (Entity ID)

Reply URL (Assertion Consumer Service URL)

Sign on URL

Relay State

Logout Uri

Required

Required

Optional

Optional

Optional

2

User Attributes & Claims

givenname

surname

emailaddress

name

Unique User Identifier

user.givenname

user.surname

user.mail

user.userprincipalname

user.userprincipalname

3

SAML Signing Certificate

Status

Thumbprint

Expiration

Notification Email

App Federation Metadata Uri

Certificate (Base64)

Certificate (Raw)

Active

5/5/2023, 11:52:22 AM

non.damir@dozuki.com

<https://login.microsoftonline.com/b16b38fe-3f...>

Download

Download

- Click the **edit icon** on the **User Attributes and Claims** tile.

Step 11 — User ID

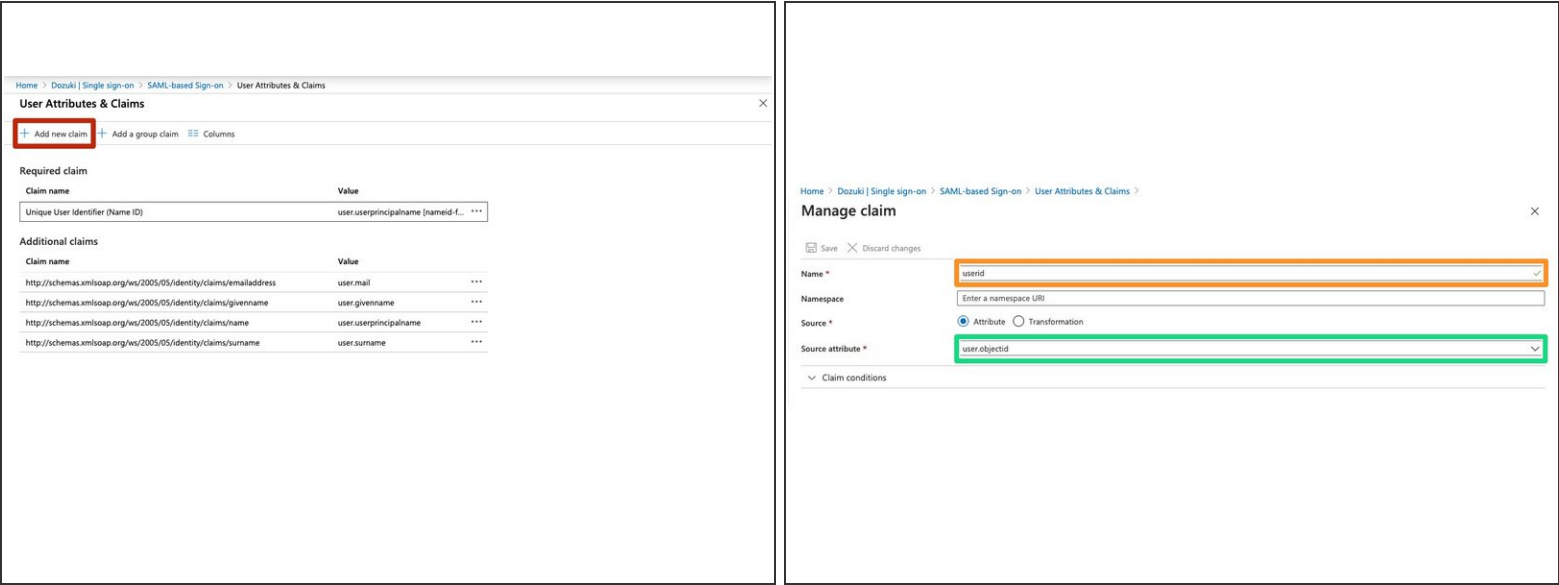

- Click on **Add a new claim** under **User Attributes & Claims**.
- Enter userid into the **Name** field.
- Enter user.objectid into the **Source attribute** field.
 - ❗ If your company uses additional unique identifiers for your users, you can use those attributes instead of user.objectid, but it should be a constant and unique value.
- Click the **Save** button to save your changes.
- Click the **'X'** at the top of the window to return to the **User Attributes & Claims** section.

Step 12 — Username

Home > Dozuki | Single sign-on > SAML-based Sign-on > User Attributes & Claims

User Attributes & Claims

+ Add new claim

+ Add a group claim

Columns

Required claim

Claim name	Value
Unique User Identifier (Name ID)	user:userprincipalname [nameid-f... ***

Additional claims

Claim name	Value
http://schemas.xmlsoap.org/ws/2005/05/identity/claims/emailaddress	user.mail ***
http://schemas.xmlsoap.org/ws/2005/05/identity/claims/givenname	user.givenname ***
http://schemas.xmlsoap.org/ws/2005/05/identity/claims/name	user:userprincipalname ***
http://schemas.xmlsoap.org/ws/2005/05/identity/claims/surname	user.surname ***

Home > Dozuki | Single sign-on > SAML-based Sign-on > User Attributes & Claims >

Manage claim

Save

Discard changes

Name *

username

Namespace

Enter a namespace URI

Source *

Attribute

Transformation

Source attribute *

user.displayName

Claim conditions

- Click on **Add a new claim** under **User Attributes & Claims**.
- Enter username into the **Name** field.
- Enter user.displayName into the **Source attribute** field.
- Click the **Save** button to save your changes.
- Click the 'X' at the top of the window to return to the **User Attributes & Claims** section.

Step 13 — Email

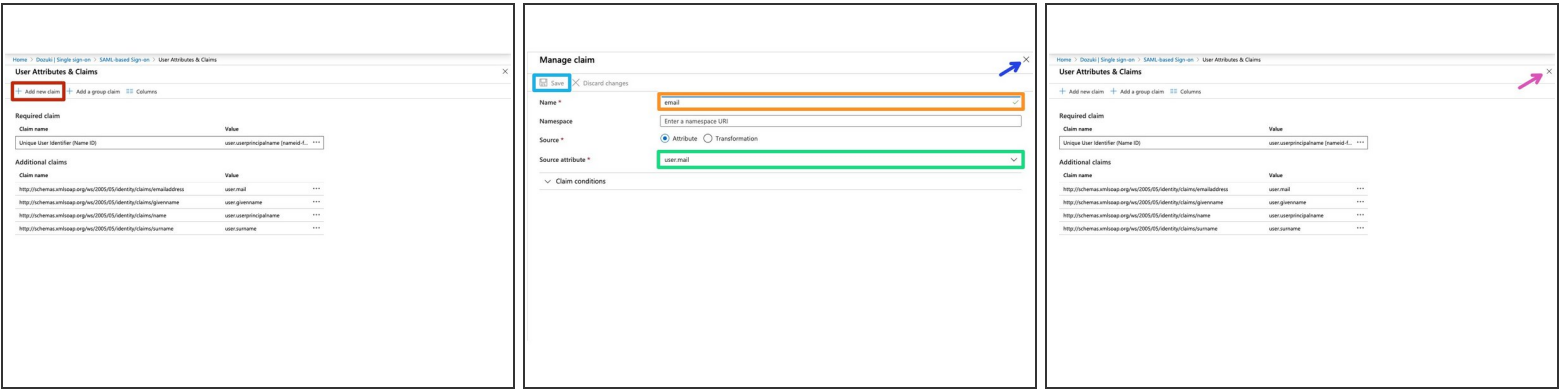

- Click on **Add a new claim** under **User Attributes & Claims**.
- Enter email into the **Name** field.
- Enter user.mail into the **Source attribute** field.
- Click the **Save** button to save your changes.
- Click the '**X**' at the top of the window to return to the **User Attributes & Claims** section.
- Click the '**X**' at the top of the window to leave the **User Attributes & Claims** settings.

Step 14 — Optional: User Attributes

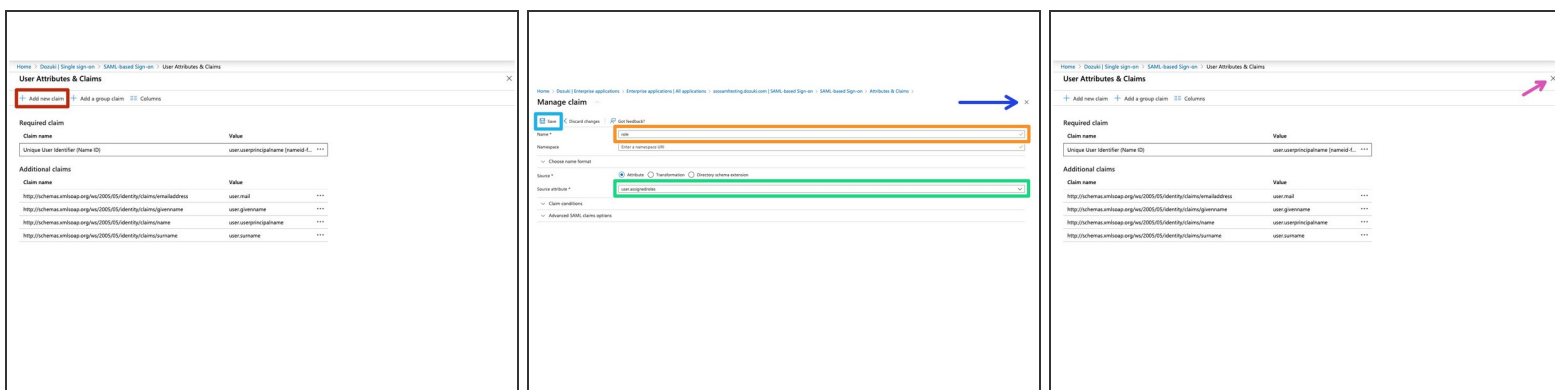

- Click on **Add a new claim** under **User Attributes & Claims**.
- Enter role into the **Name** field.
- Enter user.assignedrole into the **Source attribute** field.
- Click the **Save** button to save your changes.
- Click the **'X'** at the top of the window to return to the **User Attributes & Claims** section.
- Click the **'X'** at the top of the window to leave the **User Attributes & Claims** settings.

Step 15 — SAML Signing Certificate

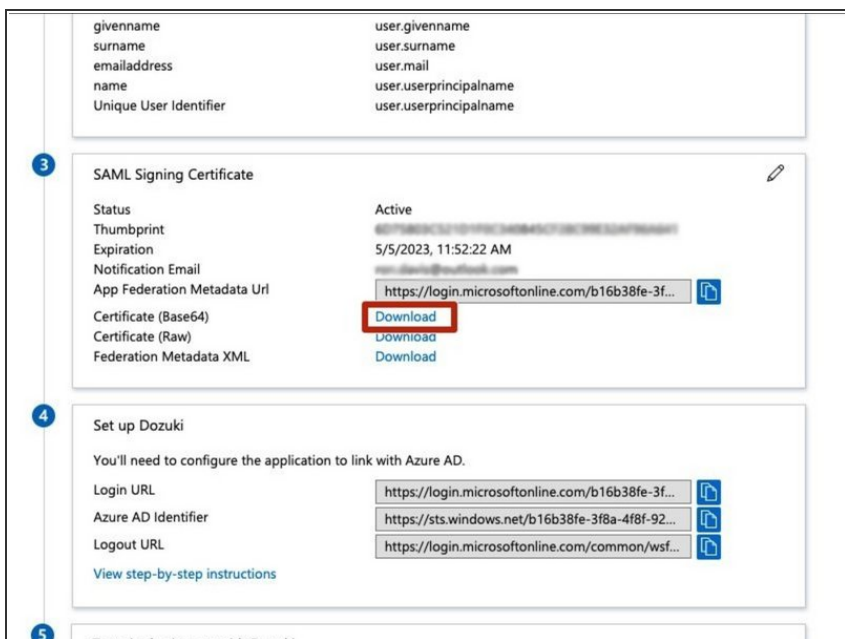

- In the **SAML Signing Certificate** section, click the **Download** link for **Certificate (Base64)**.
- Save the certificate file when prompted.
- Open the certificate in a text editor.

Step 16

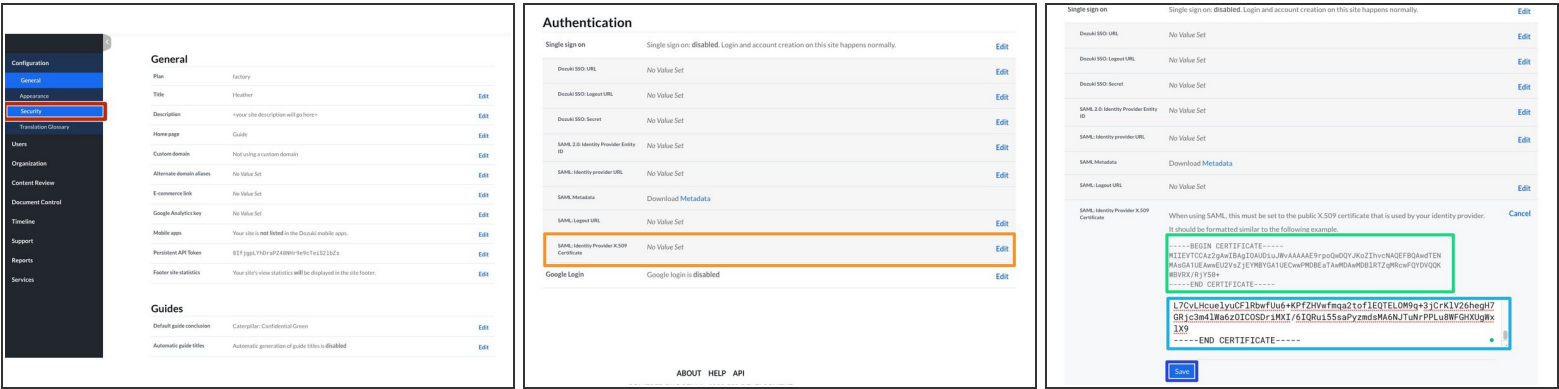

- Open the management console of your Dozuki site in another browser window.
- From the **Configuration** section in the sidebar menu, select **Security**.
- Under the **Authentication** heading section of the Security page, click on **SAML: Identity Provider X.509 Certificate**.
- Copy the body of certificate from your text editor.
 - The certificate should be formatted similar to the example shown under the **Authentication** section.
- Paste the certificate into the text field.
- Click the **Save** button to save your changes.

Step 17

3

SAML Signing Certificate

StatusActive

ThumbprintE68EF18B19101F31C647A88FB7223C926F9E7A07

Expiration5/5/2023, 12:52:07 PM

Notification Emailron.davis@outlook.com

App Federation Metadata Urlhttps://login.microsoftonline.com/b16b38fe-3f...

Certificate (Base64)Download

Certificate (Raw)Download

Federation Metadata XMLDownload

4

Set up Dozuki

You'll need to configure the application to link with Azure AD.

Login URLhttps://login.microsoftonline.com/b16b38fe-3f...

Azure AD Identifierhttps://sts.windows.net/b16b38fe-3f8a-4f8f-92...

Logout URLhttps://login.microsoftonline.com/common/wsf...

View step-by-step instructions

5

Test single sign-on with Dozuki

Test to see if single sign-on is working. Users will need to be added to Users and groups before they can sign in.

Test

Authentication

Single sign onSingle sign on: disabled. Login and account creation on this site happens normally.

Edit

Dozuki SSO: URLNo Value Set

Edit

Dozuki SSO: Logout URLNo Value Set

Edit

Dozuki SSO: SecretNo Value Set

Edit

SAML 2.0: Identity Provider Entity IDThe unique identifier for your identity provider. This must be a URI and must match the Issuer field that is sent in your identity provider's SAML 2.0 responses.

https://sts.windows.net/b16b38fe-3f8a-4f8f-9235

Save

SAML: Identity provider URLNo Value Set

Edit

SAML MetadataDownload Metadata

SAML: Logout URLNo Value Set

Edit

SAML: Identity Provider X.509 CertificateValid certificate

Edit

Google LoginGoogle login is disabled

Edit

- Copy the **Azure AD Identifier**
- Paste the **Azure AD Identifier** into the **SAML 2.0: Identity Provider ID** text field in your Dozuki site.
- Click the **Save** button to save your changes.

This document was generated on 2024-03-20 04:32:39 PM (MST).

© 2024help.dozuki.com/

Page 15 of 19

Step 18 — Test and Add Azure Connection

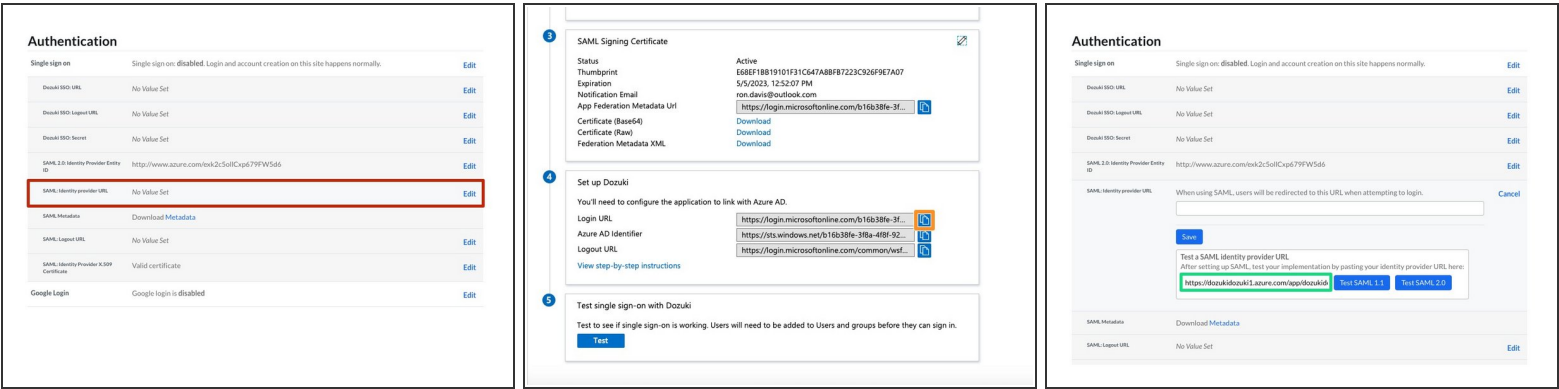

- Click on the **SAML: Identity provider URL** heading under **Authentication**.
- Under the **Set up** section in the Azure portal, click on the **Copy** icon next to **Login URL**.
- Paste the **Login URL** into the **Test a SAML identity provider URL** text field in your Dozuki site to test the SSO connection.
- We recommend testing the SAML connection through your Dozuki site before enabling SAML 2.0 as the authentication mechanism. Testing the connection from within Dozuki will prevent disruption to your active site and current users.

Step 19

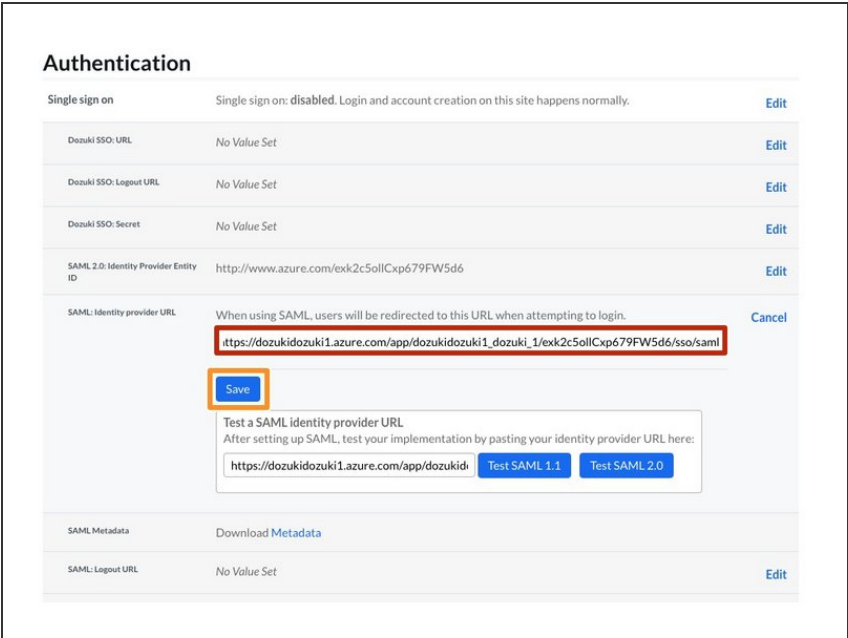

- After testing the connection, paste the **Login URL** into the **SAML: Identity provider URL** field.
- Click the **Save** button to save your changes.

Step 20 — Add Azure Logout URL

Authentication

Single sign on

Single sign on: disabled. Login and account creation on this site happens normally.

Edit

Dozuki SSO URL	No Value Set	Edit
Dozuki SSO Logout URL	No Value Set	Edit
Dozuki SSO Secret	No Value Set	Edit
SAML 2.0 Identity Provider Entity ID	https://sts.windows.net/b16b38fe-3f8a-4f8f-920f-9a14731151b3/saml2	Edit
SAML Identity provider URL	https://login.microsoftonline.com/b16b38fe-3f8a-4f8f-920f-9a14731151b3/saml2	Edit
SAML Metadata	Download Metadata	Edit
SAML Logout URL	No Value Set	Edit
SAML Identity Provider X.509 Certificate	Valid certificate	Edit
Google Login	Google login is disabled	Edit

1

SAML Signing Certificate

Status

Active

Thumbprint

E68EF18B19101F31C647A8BF87223C926F9E7AD07

Expiration

5/5/2023, 12:52:07 PM

Notification Email

ron.davis@dozuki.com

App Federation Metadata Url

https://login.microsoftonline.com/b16b38fe-3f...

Certificate (Base64)

Download

Certificate (Raw)

Download

Federation Metadata XML

Download

4

Set up Dozuki

You'll need to configure the application to link with Azure AD.

Login URL

https://login.microsoftonline.com/b16b38fe-3f...

Azure AD Identifier

https://sts.windows.net/b16b38fe-3f8a-4f8f-92...

Logout URL

https://login.microsoftonline.com/common/wsf...

View step-by-step instructions

5

Test single sign-on with Dozuki

Test to see if single sign-on is working. Users will need to be added to Users and groups before they can sign in.

Test

Authentication

Single sign on

Single sign on: using SAML. Users are being redirected to your SAML endpoint when they try to log in.

Edit

Dozuki SSO URL	No Value Set	Edit
Dozuki SSO Logout URL	No Value Set	Edit
Dozuki SSO Secret	No Value Set	Edit
SAML 2.0 Identity Provider Entity ID	https://sts.windows.net/b16b38fe-3f8a-4f8f-9235	Edit
SAML Identity provider URL	https://login.microsoftonline.com/b16b38fe-3f8a-4f8f-920f-9a14731151b3/saml2	Edit
SAML Metadata	Download Metadata	Edit
SAML Logout URL	When using SAML, users will be redirected to this URL after logging out. https://login.microsoftonline.com/b16b38fe-3f8a-4f8f-920f-9a14731151b3/saml	Cancel
SAML Identity Provider X.509 Certificate	Valid certificate	Edit

- Click on the **SAML: Logout URL** heading under **Authentication**.
- Under the **Set up** section in the Azure portal, click on the **Copy** icon next to **Logout URL**.
- Paste the **Logout URL** into the **SAML: Logout URL** text field in your Dozuki site.
- Click the **Save** button to save your changes.

Step 21 — Enable Single Sign On

Authentication

Single sign on

Single sign on: disabled. Login and account creation on this site happens normally.

Edit

Dozuki SSO URL	No Value Set	Edit
Dozuki SSO Logout URL	No Value Set	Edit
Dozuki SSO Secret	No Value Set	Edit
SAML 2.0 Identity Provider Entity ID	https://sts.windows.net/b16b38fe-3f8a-4f8f-9235	Edit
SAML Identity provider URL	https://login.microsoftonline.com/b16b38fe-3f8a-4f8f-920f-9a14731151b3/saml2	Edit
SAML Metadata	Download Metadata	Edit
SAML Logout URL	https://login.microsoftonline.com/b16b38fe-3f8a-4f8f-920f-9a14731151b3/saml2	Edit
SAML Identity Provider X.509 Certificate	Valid certificate	Edit
Google Login	Google login is disabled	Edit

Authentication

Single sign on

Single Sign On type: Disabled

Cancel

How to use SSO

Save

Dozuki SSO URL	No Value Set	Edit
Dozuki SSO Logout URL	No Value Set	Edit
Dozuki SSO Secret	No Value Set	Edit
SAML 2.0 Identity Provider Entity ID	https://sts.windows.net/b16b38fe-3f8a-4f8f-9235	Edit
SAML Identity provider URL	https://login.microsoftonline.com/b16b38fe-3f8a-4f8f-920f-9a14731151b3/saml2	Edit
SAML Metadata	Download Metadata	Edit
SAML Logout URL	https://login.microsoftonline.com/b16b38fe-3f8a-4f8f-920f-9a14731151b3/saml2	Edit
SAML Identity Provider X.509 Certificate	Valid certificate	Edit
Google Login	Google login is disabled	Edit

Authentication

Single sign on

Single Sign On type: Disabled Dozuki SSO SAML SAML 2

Cancel

How to use SSO



Save



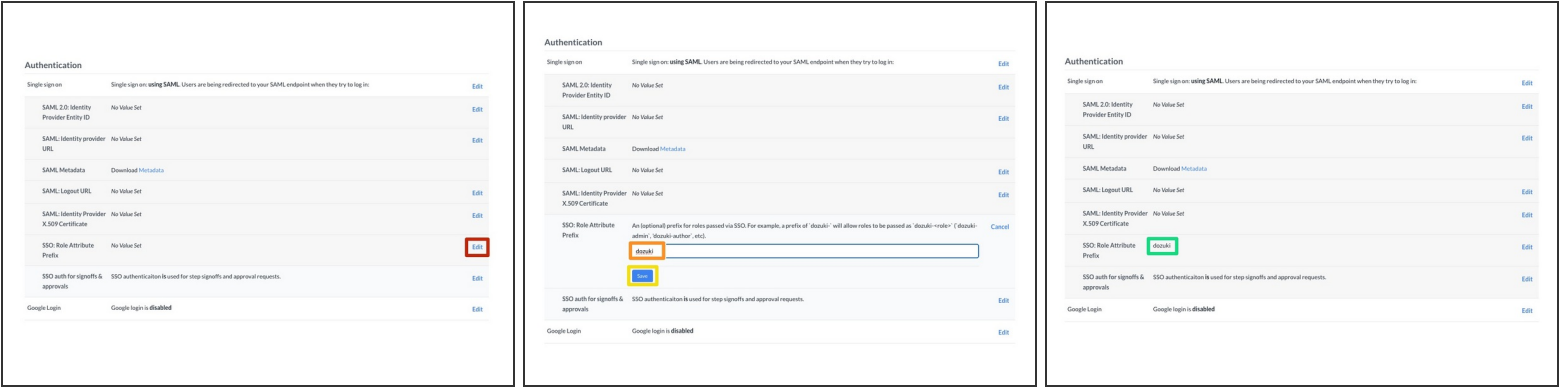

Dozuki SSO URL	No Value Set	Edit
Dozuki SSO Logout URL	No Value Set	Edit
Dozuki SSO Secret	No Value Set	Edit
SAML 2.0 Identity Provider Entity ID	https://sts.windows.net/b16b38fe-3f8a-4f8f-9235	Edit
SAML Identity provider URL	https://login.microsoftonline.com/b16b38fe-3f8a-4f8f-920f-9a14731151b3/saml2	Edit
SAML Metadata	Download Metadata	Edit
SAML Logout URL	https://login.microsoftonline.com/b16b38fe-3f8a-4f8f-920f-9a14731151b3/saml2	Edit
SAML Identity Provider X.509 Certificate	Valid certificate	Edit
Google Login	Google login is disabled	Edit

- Click on the **Single sign on** heading under **Authentication**.
- Click on the **Single Sign On type** dropdown menu.
- Select **SAML 2** from the dropdown menu.
- Click the **Save** button to save your changes.

Step 22 — SSO: Role Attribute Prefix



-  Once SSO is enabled on your Dozuki site, you have the option to add a role attribute prefix. This helps when syncing to third-party IdPs and will allow roles to be passed as `dozuki-<role>` (`dozuki-admin`, `dozuki-author`, etc.)
-  *Dozuki defined roles (admin, author, user, etc.) **cannot** be customized.*

-  Click **Edit**.
-  Add your desired role attribute prefix.
-  Click **Save**.
-  Your role attribute prefix will be displayed.

Step 23 — SSO Authentication for Signoffs & Approvals

Authentication

Single sign on

Single sign on: using SAML. Users are being redirected to your SAML endpoint when they try to log in:

Edit

Dozuki SSO: URL	No Value Set	Edit
Dozuki SSO: Logout URL	No Value Set	Edit
Dozuki SSO: Secret	No Value Set	Edit
SAML 2.0: Identity Provider Entity ID	https://app.onelogin.com/saml/metadata/d9b84655-33fc-4b86-a339-55cab7eed24	Edit
SAML: Identity provider URL	No Value Set	Edit
SAML Metadata	Download Metadata	
SAML: Logout URL	No Value Set	Edit
SAML: Identity Provider X.509 Certificate	Valid certificate	Edit

SSO auth for signoffs & approvals

Enables users to authenticate step signoffs and approval requests with SSO instead of using Dozuki passwords.

Cancel

☒ Use SSO authentication for step signoffs and approval requests.

Save

Google Login

Google login is disabled

Edit

- Once Single Sign On is enabled, **SSO auth for signoffs & approvals** will appear in the Authentication section of the Security settings.
- ⓘ This feature allows users to enter their SSO authentication for Signoffs and Approvals instead of a separate Dozuki password.
- SSO auth for signoffs & approvals is enabled by default when you enable SSO authentication.
- ✳ Only disable SSO authentication for signoffs & approvals if you want your users to enter a **separate Dozuki password** for signoffs and approvals.