



How to Add Flags to a Guide

This guide demonstrates how to add flags to a guide.

Written By: Dozuki System



INTRODUCTION

This guide demonstrates how to add flags to a guide.

Reminder

Any changes made to a guide, with the exception of tags and the default language, create a new draft of the guide.

Step 1 — Edit Guide

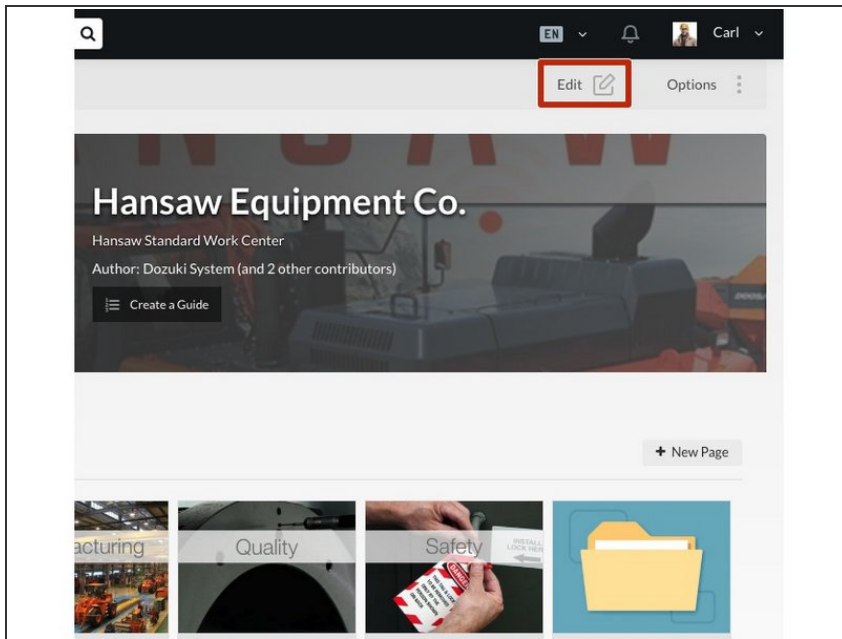

- Navigate to the guide that needs a flag(s).
- Click on the **Edit** button in the top-right of the page, beneath the site header.

Step 2 — Add a Flag

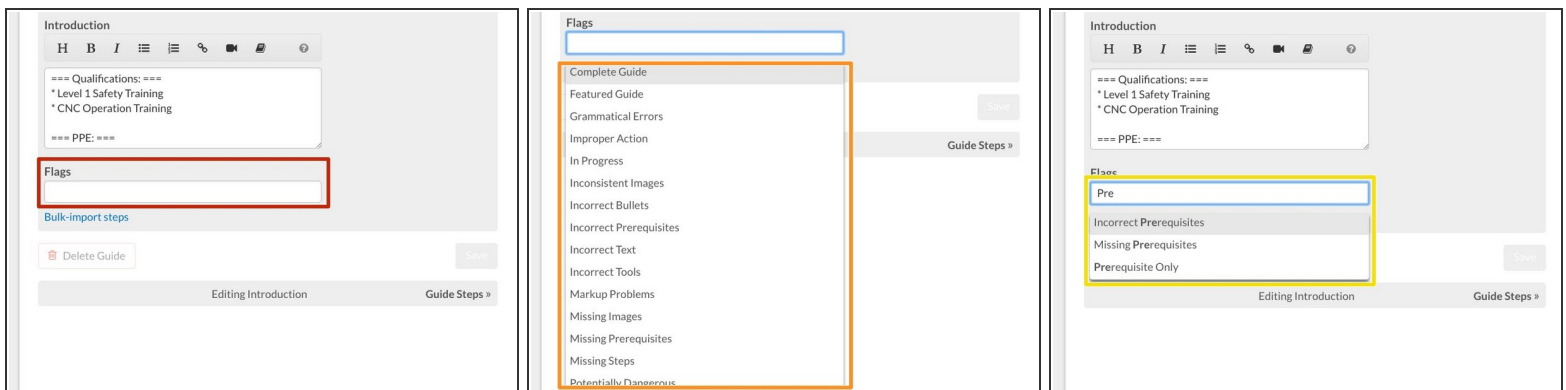

- Click inside the **Flags** field near the bottom of the Introduction page.
- Select a **Flag** from the drop-down menu.
- To narrow the list, you can also type the title of the flag you need.

Step 3 — Save Added Flags

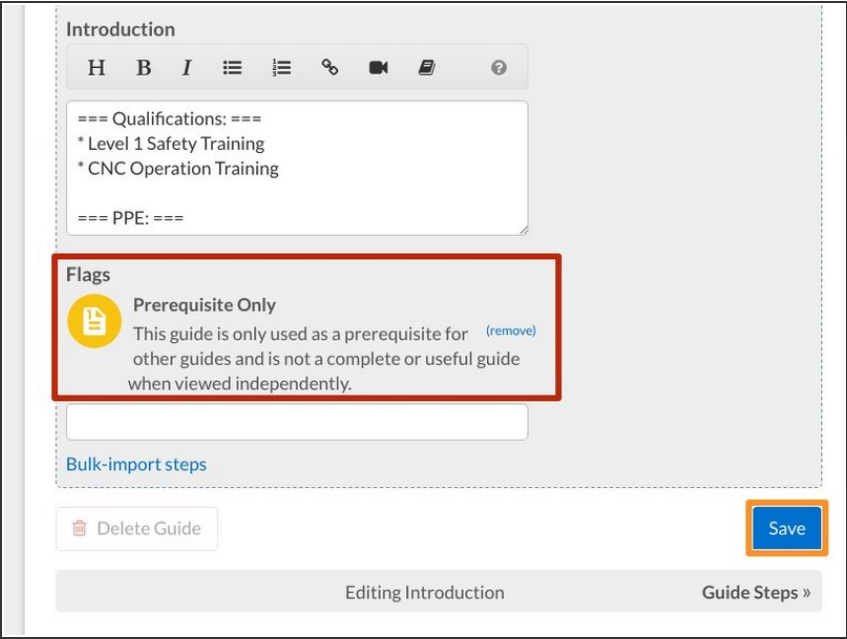

- Your selected flags will appear above the search field.
- Click on the **Save** button.

Step 4 — View Flag

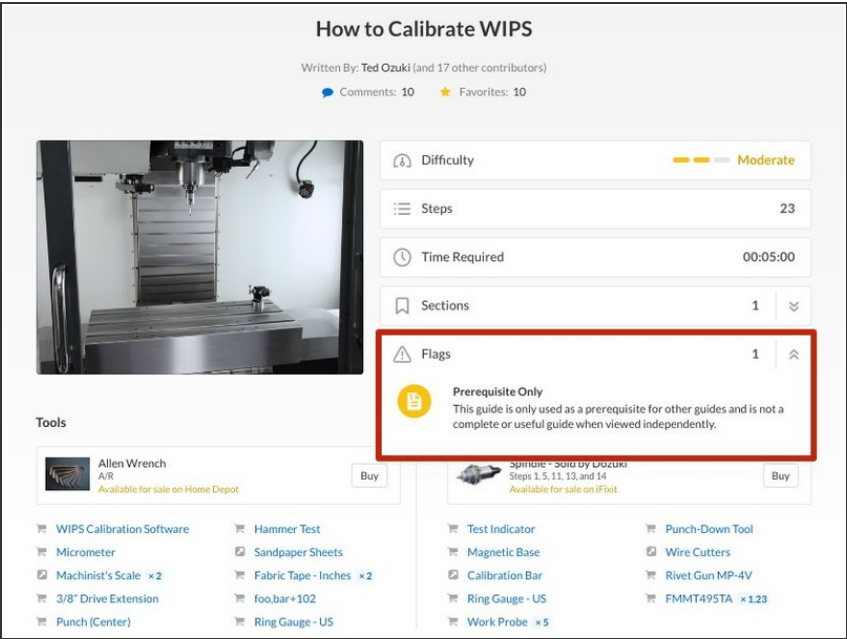

- Click **View Draft** in the upper-right of the page, beneath the site header.
- **View** your guide to see the Flag.